

gemini
ITALY

MULTI-FUNCTIONAL
ELECTRIC COOKER
多功能煮食鍋
Model No.型號: GMC500
600-700W

Before using your product for first time, please read this instruction manual.
在使用本產品前，請仔細閱讀本說明書並保存好。

SAFETY INTRUCTIONS

1. Please read these instructions carefully and retain them for reference.
2. This appliance is not intended for use by persons (including children under 8 years old) with reduced physical, sensory or mental capabilities, or lack of experience and knowledge, unless they have been given supervision or instruction concerning use of the appliance by a person responsible for their safety. Children should be supervised to ensure that they do not play with the appliance.
3. All the repairs carried out solely by a qualified electrician. Never try to repair the appliance yourself.
4. Use this appliance solely in accordance with these instructions.
5. Never use the appliance at outdoors or in a humid room.
6. Before start use, ensure the power supply same as indicate at the appliances. The power supply should has earth wired.
7. Appliances should place at a stable platform, and keep away from children.
8. When power cable damages, please contact service center for replacement. Do not replace it by own.
9. While selecting the features, do not press the button with great force, it will damage the button and control panel.
10. Any faulty operation, must switch off power and unplug the power supply. Do not unplug while your hand is wet, because will get electric shock.
11. Do not pull the line along sharp object / sharp edges, crimp the wire or let it hang down. Also put away from hot heating and wet condition.
12. Do not insert any metal object into to the heat dissipation holes / gaps, otherwise it cause electric shock.
13. Do not place the product on the surface or beside extreme heat condition, such as oven.
14. It is forbidden to use this product on an unstable / inclined platform to avoid accident such as injury or fire cause by products falling over.

- 15.Keep away from children or in-experienced person to operate this product.
- 16.While in process, it is normal that the pot body is hot when pouring water or soup out, please lift the pot by holding the handle. Do not touch the pot body with hands directly, this would get hurt.
- 17.Please keep the surface of the heating plate clean. After using it for a period of time, please clean the dirt on the surface of the heating plate.
- 18.The product will generate steam when it is working. It is easy to cause burns from the steam port. Please be careful while using it.
- 19.Do not allow liquid to flow into the product during cleaning, and to avoid danger do not allow the power cord, plug, main body, etc. to dip in the water.
- 20.If the product is dry burn, please add water to the pot or unplug the power supply. At this time, do not touch the heater with your hands to avoid scalding.
- 21.After use, there is residual heat in the body and heating plate. Be careful of scalding.
- 22.Please keep the surface of the heating plate clean. After using for a period of time, the dirt on the surface of the heating plate and the scale on the inner wall of the pot must be cleaned in time.

**This appliance is intended for HOUSEHOLD ONLY.
It is not intended for commercial use.**

PRODUCT REVIEW

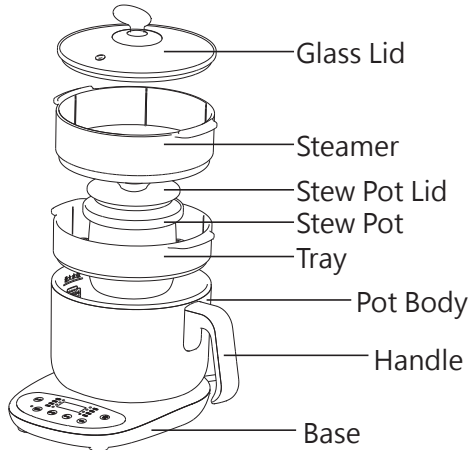

Note :

The picture is for reference only, assemblies maybe different from the picture.

CONTROL PANEL

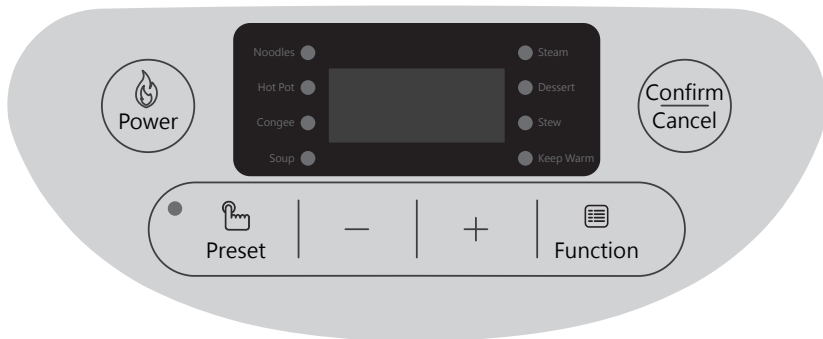

"Confirm/Cancel" button: After the power on, the product will enter the standby mode. After select the function, press "Confirm/Cancel" button then starts to work. Around 10 seconds later, it will operate, and if press "Confirm/Cancel" button during the work, the product will back to standby mode.

"Function" button: In function mode, press this button to select the function. When selected the function, the corresponding function indicator will flash. If there is no other operation, the product will start work automatically in 10 seconds later, the indicator light will turn on.

"Power" button: After the function is selected, press this button to change the heating power of the product (from 100W to 600W, in 6-level). You can also press this button to change the heating power after it starts working. If you do not press this button, the product will work according to the programmed power.

Remark: Heating power cannot be adjusted in the water-proof stewing function.

"Preset" button: In standby mode, press the preset button to enter the preset mode(time range 0.5 – 9.5 hours). After setting the preset time, press the "Function" button to select the function, the product will operate after you set the preset time.

For example: If you want to make soup after an hour, select the time by pressing the "Preset" button at 1:00, press the "Function" button to select the soup function, and the product will start working after one hour automatically .

"Standby" mode: Switch on the power, the product has "beep" sound, display screen shows "---" .

"Function" mode: Switch on the power, and select function.

"Operation" mode: the corresponding function indicator is always on, the heating tube is on, and the display screen shows the operating time.

After starting the "Preset" function: During the preset process, the corresponding function indicator light is on, and the preset time will count down and show on the display screen. when the time counts to zero, the product will enter to the operating mode.

End of operation: when the program is completed, the product will enter to keep warm mode.

Table of default and pre-set time of each function :

Function	Stewing	Hot Pot	Steam	Keep warm (Function Selected)	Congee	Soup	Noodles	Dessert
Preset working Time	0 : 50	2 : 00	0 : 45	4 : 00	1 : 00	1 : 20	0 : 25	1 : 10
Maximum time setting	2 : 30	3 : 00	1 : 30	4 : 00	1 : 45	2 : 00	0 : 35	1 : 45
Minimum time setting	0 : 05	0 : 05	0 : 05	0 : 30	0 : 05	0 : 05	0 : 05	0 : 05
Default keep-warm time	8 : 00	2 : 00	2 : 00	---	2 : 00	2 : 00	---	2 : 00

* '---' means does not have this function.

By adjusting the power, some of the function will be changed with the working range. Detail as below:

Function	Power (W)	Preset time	Working range
Congee	500-600	1 : 00	0 : 05-1 : 45
	300-400	1 : 25	0 : 05-2 : 00
	100-200	1 : 40	0 : 05-2 : 30
Soup	500-600	1 : 20	0 : 05-2 : 00
	300-400	1 : 45	0 : 05-2 : 30
	100-200	2 : 00	0 : 05-3 : 00
Noodles	500-600	0 : 25	0 : 05-0 : 35
	300-400	0 : 30	0 : 05-0 : 45
	100-200	0 : 50	0 : 05-1 : 20
Dessert	500-600	1 : 10	0 : 05-1 : 45
	300-400	1 : 35	0 : 05-2 : 00
	100-200	1 : 50	0 : 05-2 : 30

OPERATION METHOD

Tips:

Before use the product for the first time, fill it with water to the highest water level, pour it out after boiled and rinse with cold water, repeat this practice twice.

When use it for the first time, there is burning smell and slight smoke, which is normal. After using for more than ten minutes, the burning smell and smoke will be disappeared.

1. Put all the ingredients into the stainless steel pot and add some water, cover the glass lip, place the pot on the base.

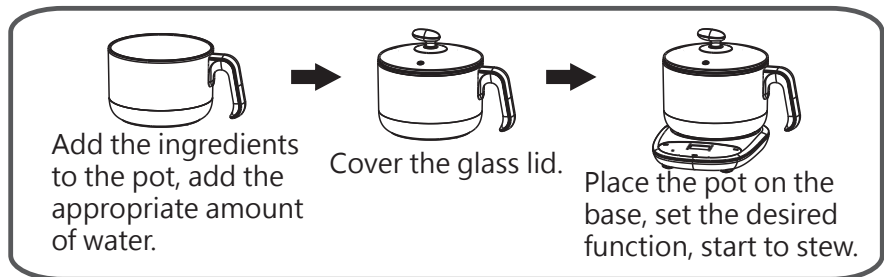

Attention:

- 1) The water should not be lower than the minimum water level, or exceed the maximum water level.
- 2) Please make sure that the pot body is placed on the base. No other objects put between the pot body and the base. Otherwise the product can not work properly.
- 3) When cooking noodles, porridge, desserts or some foamed soups, the glass lid can be opened after the water is boiled, and then stir properly to prevent spillage.
- 4) When using the water-proof stew function, put 1 liter of water in the pot (about 2/3 of the pot), too much water might overflow, not enough water might dry up.

2. After power on, the machine will enter the standby mode automatically, press the "Function" button to select function.
3. Press the "Function" button, the indicator light of the selected function flashes (for Power or Preset adjustment)press "Power" or "Preset " to set the required time. If both are required, it is required to set the power first, and then set the preset time.), if no other operation within 10 seconds, the product will operate automatically.
4. During the working process, press the "Confirm/Cancel" button again to cancel the operation and return to standby mode.
5. When the operation is done, the product will beep and in the keep warm mode or off automatically. The food is ready.

Stewing Function	Recommended Setting Time
Peach Gum	1:10
Grains Porridge	1:10
Mung Bean Soup	1:40
Soup	1:40

Tips:

The stewing time should be adjusted according to the actual requirements, do not use other functions for stewing.

Frying food

When frying eggs or other food, please add proper amount of cooking oil into the pan. During frying, please use a wooden spatula or chopsticks to stir so as not to damage the coating. After frying, please turn off the power and wait for the product to cool down before cleaning.

Tips: When frying food, please do not put on the lid to avoid overheat of the lid and burn during use.

CLEANING AND MAINTENANCE

1. After used, please unplug from the power socket in time.
2. Each component can be cleaned with detergent and sponge. Do not use hard steel wire to avoid damage to the surface.
3. To remove the scale of the pot, pour 20mL of white vinegar on the heating plate and soak it for 15 to 20 minutes, then rinse with clean water.
4. Do not immerse the host in water. The outer surface of the product can only be wiped with a wet towel, and must not be washed with water to avoid electric leakage and malfunction.
5. When using or moving the electric cooker, it is necessary to handle it gently. It is strictly forbidden to move the electric cooker with electricity on.
6. When the product is not used for a long time, please clean it, put it in the packaging box, and place it in a ventilated and dry place to prevent moisture from affecting the usage.

FREQUENTLY ASKED QUESTION

Indicator is off, the appliance does not work:

- Whether the power on?
- Whether the power plug is plugged in?
- Whether the power socket is turned off?

Notice:

If still cannot solve the abnormal phenomenon after analysed above problems, please contact with service centre. It is strictly forbidden for non-professionals to disassemble the product.

SPECIFICATIONS

Model No.: GMC500

Voltage & Frequency: 220-240V~ 50-60Hz

Power : 600-700W

Capacity: 1.2 liters Max.

Product Dimension: 236(W) x 282(H) x230(D) mm (With steamer)

Product Dimension: 227(W) x 201(H) x230(D) mm (Without steamer)

***The final product specification may be varied according to a different lot of material and actual input voltage power of the usage area.**

安全指引

1. 請於操作前詳閱操作指引，避免使用不當而造成損壞或危險。
2. 8歲以下兒童、傷健人仕、精神及感官受到影響及缺乏操作常識和經驗者不適宜獨立操作此產品。如需操作需有相關人仕從旁指引及對其行為安全負責。
3. 如本產品出現問題，請聯絡代理商或合資格人仕處理，不要自行進行維修以免發生危險。
4. 請根據本說明書指示操作本產品。
5. 請勿在室外或者濕度高的室內使用本產品。
6. 使用前請確保插座的接地有效，同時請確認輸入電壓為220-240V~50-60Hz。
7. 本產品應放置在穩定的平臺上，並遠離兒童。
8. 如電線損壞時，請聯絡維修部安排更換。切勿自行更換。
9. 操作按鍵時不可用力過猛，以防按鍵損壞。
10. 在使用過程中，若發生問題時，請先將電源插頭從插座上拔下；禁止濕手拔/插插頭，以免觸電。
11. 請勿以尖端物或鋒利邊沿來拽線、壓線或讓它懸垂下來，同時要遠離熱源和濕源的地方。
12. 不要將金屬等異物插入散熱孔或間隙中，否則可能導致電路損壞。
13. 切勿將本產品放置在帶熱源的表面上或熱源旁，如焗爐等。
14. 禁止放置在不平或傾斜的枱面上使用本產品，避免產品容易傾倒引起傷害或火災等事故。
15. 本產品不適用於兒童、精神病患者或缺乏經驗的人使用或把玩本產品。
16. 產品使用過程中，其鍋身變熱是一種正常現象，當倒水時，請拿起手柄來提起鍋身，切勿用手接觸鍋身的高溫表面，以免燙傷。
17. 請保持機器發熱盤表面清潔，使用一段時間後，需清理發熱盤表面的污垢。
18. 產品使用時，會產生蒸氣從蒸氣噴出，這容易引起燙傷，請務必小心。
19. 清洗時請勿讓液體流入產品內部，也不可將電源線、插頭、整機等浸入液體裏，以免發生危險。
20. 若產品出現乾燒情況，請往鍋內加水或拔掉電源，切勿觸摸發熱體以防燙傷。
21. 使用後鍋身與發熱盤會有餘熱，小心燙傷。
22. 請保持電熱鍋發熱盤表面清潔，使用一段時間後，必須及時清理發熱盤表面的污垢及鍋身內壁水垢。

注意！ 此產品只適合家庭用途，並不適用於商業用途。

部件示意圖

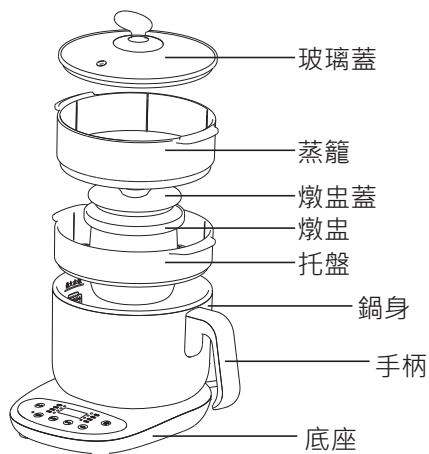

注意:如產品圖片與實物略有不同,請以實物為準。

使用步驟



“確認/取消”鍵：接通電源後，產品進入待機狀態，選定功能後按“確認/取消”鍵產品便開始工作，或10秒後開始工作，在工作過程中再按“確認/取消”鍵，產品會進入待機狀態。

“功能”鍵：在功能選擇狀態，通過按此鍵來選擇所要使用的功能，選定所需功能後，對應功能的指示燈閃爍，如無其他操作，產品10秒後自動開始工作，指示燈長亮。

“火力” 鍵：在選定功能後，按此鍵可以改變產品加熱功率（在100-600瓦間選擇，分為6檔）。也可以在產品開始工作後，按此鍵改變產品的加熱功率。如果不按此鍵，產品則按程式預設功率工作。備註：隔水燉功能不能調較加熱功率。

“預約” 鍵：在待機狀態時，按“預約” 鍵進入預約模式加預約時間（可預約範圍：0.5小時至9.5小時），設定好預約時間後，再按“功能” 鍵選擇功能，使產品能夠在設定預約時間後才開始工作。

如：如果想要產品在一個小時後開始煲湯，通過按“預約” 鍵選擇時間為1:00，再按“功能” 鍵選擇煲湯功能，這樣一小時後產品自動開始工作。

待機狀態：接通電源，產品蜂鳴一聲，顯示幕顯示“- - -”。

功能選擇狀態：接通電源後，按“功能” 鍵選擇程序，選定。

工作狀態：對應功能指示燈常亮，發熱管加熱，顯示屏顯示加熱功能剩餘時間。

啟動“預約” 功能後：在預約過程中，對應功能指示燈亮，預約時間是以倒數方式在顯示屏顯示，時間歸零後，產品進入工作狀態。

工作結束：當產品工作結束後，產品進入保溫功能。

預設烹調時間(分鐘)：

功能	隔水蒸	火鍋	蒸煮	保溫(功能選擇)	煮粥	煲湯	煮麵	甜品
預設工作時間	0 : 50	2 : 00	0 : 45	4 : 00	1 : 00	1 : 20	0 : 25	1 : 10
最大設置時間	2 : 30	3 : 00	1 : 30	4 : 00	1 : 45	2 : 00	0 : 35	1 : 45
最小設置時間	0 : 05	0 : 05	0 : 05	0 : 30	0 : 05	0 : 05	0 : 05	0 : 05
保溫時間	8 : 00	2 : 00	2 : 00	---	2 : 00	2 : 00	---	2 : 00

* 表中 “---” 表示沒有此項功能。

個別功能工作時間因為功率調節有所改變，請參考下表：

功能	功率(瓦)	預計時間	工作時間
煮粥	500-600	1 : 00	0 : 05-1 : 45
	300-400	1 : 25	0 : 05-2 : 00
	100-200	1 : 40	0 : 05-2 : 30
煲湯	500-600	1 : 20	0 : 05-2 : 00
	300-400	1 : 45	0 : 05-2 : 30
	100-200	2 : 00	0 : 05-3 : 00
煮麵	500-600	0 : 25	0 : 05-0 : 35
	300-400	0 : 30	0 : 05-0 : 45
	100-200	0 : 50	0 : 05-1 : 20
甜品	500-600	1 : 10	0 : 05-1 : 45
	300-400	1 : 35	0 : 05-2 : 00
	100-200	1 : 50	0 : 05-2 : 30

使用方法

溫馨提示：

初次使用本產品前，應注水至最高水位，沸騰後倒掉並用冷水沖洗，重複此步驟二次。

首次使用時或會有燒焦味及微煙產生，此乃正常現象。使用十幾分鐘後燒焦味及微煙就會消失。

1. 不銹鋼鍋身內放入需要燉煮的各類食材並加入適量的水，蓋上玻璃蓋，再把鍋身放置在底座上面。



注意：

- 1) 放入的水不能低於最小水位線，也不要超過最大水位線。
- 2) 請務必將鍋身正放於底座上，鍋身和底座之間不能有其他物體或異物，否則產品將無法正常工作。
- 3) 煮面、煲粥、甜品或一些易發泡的湯時，水開後可將玻璃上蓋揭開，然後適當的進行攪拌，以防止溢出。
- 4) 燉煮功能使用時，鍋內放水1升（約鍋內的2/3處）太多會溢出，太少易燒幹。

2. 產品接通電源後，機器自動進入待機狀態，按“功能”鍵進入功能選擇狀態。

3. 按“功能”鍵，所選功能對應的指示燈閃爍（如需進行火力調節或預約設置，可按“火力調節”或“預約”鍵設定所需時間，如兩者均需設定，需先將火力調節設置好後，再進行預約設置），10秒鐘內無其他操作，產品將自動開始工作。

4. 工作過程，再按一次“確認/取消”鍵，可取消工作，返回待機狀態。
5. 產品工作完後，產品發出滴滴滴.....響聲，產品自動轉入保溫狀態或結束工作，食物可以食用。

燉煮	建議設定時間
燉桃膠	1:10
燉粥	1:10
燉綠豆沙	1:40
燉湯	1:40

溫馨提示：燉煮時間可以根據實物要求調節，不要用其他功能來燉煮。

煎製食物

煎雞蛋等食物時，請先將適量食油加入鍋中，煎製過程中，請用木鏟或者筷子進行翻炒，以免破壞塗層。煎制完畢請關閉電源開關，待器具冷卻後再清洗。

溫馨提示：煎炒食物時，請勿蓋上蓋子，以免蓋子溫度過高，使用過程中燙傷。

清潔及保養

1. 使用完畢後，請從電源插座上拔下插頭。
2. 各部件可用洗潔精和海綿清洗，請勿使用硬質鋼絲清洗，以免破壞表面。
3. 鍋身水垢的清除方法，倒入20毫升的白醋在發熱盤上浸泡15到20分鐘，再用清水沖洗即可。
4. 切勿將主機浸入水中，產品外表面僅可用濕毛巾擦拭，不得用水清洗，以免發生漏電及發生故障。
5. 使用或移動電熱鍋時，需輕拿輕放，嚴禁帶電移動煮食鍋。
6. 產品長時間不使用時，請清潔乾淨，裝入包裝箱中，置於通風乾燥的地方，以免受潮，影響使用。

常見問題分析

- 1、開機沒回應，指示燈不亮。
 - a· 是否停電？
 - b· 電源線是否插入插座中？
 - c· 電源線插座是否關閉狀態？

備註：

經以上現象分析後仍無法排除故障，請與本公司客戶服務中心，嚴禁非專業人員對本機自行拆裝。

產品規格

型號：GMC500

電壓：220-240V~

頻率：50-60Hz

功率：600-700W

容量：1.2公升（最大）

產品尺寸: 236(闊) x 282(高) x 230(深) 毫米 (含蒸架)

產品尺寸: 227(闊) x 201(高) x 230(深) 毫米 (不含蒸架)

*相關產品的規格，可能會因配件批次或實際使用地區的電壓差異而有所不同。

請記錄下列產品資料

● 型號

● 機身編號

● 經銷商名稱

● 購買日期

本產品不斷改進中，如功能有所更改，恕不另行通知，如有疑問，請與客戶服務中心聯絡，不便之處，敬請原諒。

說明書內容以英文版本為準

ToolBox Customer Service Centre 客戶服務中心：
4/F, DCH Building, 20 Kai Cheung Road, Kowloon Bay, Hong Kong
香港九龍灣啓祥道20號大昌行集團大廈4樓

Customer Service Hotline 客戶服務熱線：(852) 8210 8210

Service E-mail 電郵地址：8210service@gilman-group.com

Please register now at 請即上網登記：www.toolbox.hk

Website 網址：www.gilman-group.com



Proudly Serviced by:



太平家庭電器